

sapa:

buildingsystem

ARCHITECTURAL ALUMINIUM SOLUTIONS



Ground Floor Treatments

Technical Data Sheet

Non-thermally Broken Commercial Entrance Door & Framing

Sapa Building System

202 Non-thermally Broken Commercial Entrance Door & Framing

- **Flexible design:** The Sapa 202 Non-thermally Broken Commercial Entrance Door and Framing range includes a non-thermally broken door and non-thermally broken framing.
Together they offer specifiers a choice of configurations to suit the specific demands of their clients.
Choice of pivot (with anti-finger trap stile option) or rebated doors can be installed with a BS8300 bottom rail adaptor, Part M compliant drained threshold and upto 32mm glazing. Designed to accept a wide range of industry standard hardware including Dorma, Axim and Adams Rite.
- **Dual colour capability:** The 202 Non-thermally Broken Commercial Entrance Door and Framing and Dualframe systems can have differing finishes internally and externally.
- **Integrated design:** The 202 suite consists of a range of profiles that can be integrated with other products from the extensive range of systems including curtain walling.
- **Ease of maintenance:** The design of the 202 system ensures that cleaning and other maintenance can be carried out easily.

■ Product

202 Non-thermally Broken Commercial Entrance Door and Framing.

■ Design Variants

Can be constructed to form single or double doors to be inserted directly into masonry, side frames or curtain walling.

■ Compatibility

Can also be integrated with other products from the Sapa range including Dualframe and Elegance 52 curtain walling.

■ Application

Suitable for installation in new build or replacement projects in commercial or public buildings.

■ Finishes

A wide range of polyester powder coat finishes is available to BS EN 12206:1 2004. Anodised finishes are to BS 3987 Grade AA25 etch silver with a range of special anodised finishes on application.

For more details, or to talk to a Project Consultant, contact the Marketing Department on 01684 853500.

202 Non-thermally Broken Commercial Entrance Door & Framing

Composition and Manufacture

Aluminium profiles are extruded from aluminium alloy 6060 T6 complying with the recommendations of BS EN 755-9:2001.

Weathersealing is a combination of polypropylene backed woven pile and extruded synthetic rubber seals held in undercut grooves extruded in the aluminium profiles.

Frame members are square cut for jointing with self tapping screws fixing into screw splines extruded in the aluminium profiles. Door leaf profiles are square cut and assembled with extruded aluminium brackets and clamp plates then fixed with M8 socket cap head machine screws. All joints are sealed against water entry during fabrication (see weather performance).

Weather Performance

There are no recognised performance standards for air and water leakage through commercial doors. Where certified weather performance is a requirement we recommend you consider the Sapa ST Thermally Broken Commercial Door and Framing system which has been tested in line with BS 6375: Part 1:2004.

In keeping with industry recommendations, it is advisable to give special consideration to doors on exposed sites. High wind pressures can cause inadvertent opening of pivoted doors and consequent draughts and water penetration. It may be advisable under such circumstances to provide protection by means of a porch or lobby.

All joints must be coated with Tremco small joint sealant or similar in order to effectively seal the frame and leaf assembly from water penetration.

Authority

BS 6262: Code of practice for glazing for buildings.

BS EN 755-9: Aluminium and aluminium alloys. Extruded rod/bar, tube and profiles. Profiles, tolerances on dimension and form.

BS 3987: Specification for anodic oxide coatings on wrought aluminium for external architectural applications.

BS EN 12206:1 2004: Specification for powder organic coatings for application and stoving to aluminium alloy extrusions, sheet and perforated sections for external architectural purposes.

Hardware and Security

The standard fittings provided for these doors are:

Dorma RTS85 concealed overhead door closers for pivoted doors and Dorma pivot hinges for rebated doors.

Adams Rite MS 2200 security lock with hook bolt and European standard profiles cylinders with optional Adams Rite 4022 head and cill bolt to top and bottom of door.

Aluminium tubular pull handles and pad handles.

Variations by way of special handles, pivot hinges, latch lock, master key systems, emergency exit devices (as shown in the Sapa Product Manual), automatic door operation, electronic security etc can all be incorporated into the system as required.

Glazing

Glass must conform to the requirements of BS6262 for thickness and type. Glass is set dry against synthetic rubber gaskets. Glass is supported on adjustable setting blocks. Glazing beads and gaskets will accommodate glass and/or panels of 28mm and 32mm nominal thickness.

Site Work

Fabrication, installation and glazing service is available through a nationwide network of fabricators & installers. For details of suitable fabricators & installers, please contact our Marketing Department on 01684 853500.

The Glostal 202 system is a suite of commercial entrance doors and ground floor framing

■ Introduction

- A range of swing, hinged and sliding doors and framing for commercial entrances in new buildings or refurbishment work
- A range of options are available to cater for all applications, from shop-fronts to glazed facades.
- A high performance 'Stormforce' Door is available for unrivalled weather performance
- A heavy-duty 'Hawk' Sliding Door option is ideal for large openings
- Anti-Finger Trap Stiles are available for centrally pivoted swing doors
- Fully compatible with Glostal 313 and 312 Curtain Walling systems, and the Glostal 317 and 325 ranges

■ The Glostal Product Range

- The Glostal range includes low and high rise curtain walling and sloped glazing, ground floor framing and entrance doors, a comprehensive range of thermally broken casement, TBT and pivot windows, many with dual colour options, for use in normal or high performance applications and vertical or horizontal sliding windows.
- A range of patio doors, residential entrance doors, sliding interior doors and secondary glazing is also available.

■ Finishes

- The product range is available in all major powder coat colours including Colour Dimensions, RAL, Syntha Pulvin and BS specifications for profiles and colour co-ordinated fittings.
- Anodised finishes are available including Anolok and Sandalor.
- For full details, including relevant quality standards, please refer to our Colours and Finishes data sheet.

■ Distribution

- The complete Glostal range of products is available throughout the United Kingdom from a nationwide network of Sapa fabricators and installers.
- These companies, selected for experience, reliability and expertise, offer a comprehensive service covering all aspects of a project from estimating to final installation.

■ Technical and Design Service

- Sapa Consultants are always available to provide specialist advice and detailed technical information on the complete range of products and services.
- Whilst the range of products is both comprehensive and versatile we are happy to discuss the production of new or modified products to meet specific project requirements.

■ Authority

BS EN ISO 9000: 1994. Sapa is listed in the BSI Register of Firms of Assessed Capability Registration Number FM1154.

BS 4873 1986. Specification for aluminium alloy windows.

BS 6375 Part 1 1989. Classification for weather tightness.

BS EN 755-9:2001. Aluminium and aluminium alloys - Extruded rod/bar, tube and profiles.

BS 6262 1982. Code of practice for glazing for buildings.

BS 3987 1991. Specification for anodic oxide coatings on wrought aluminium for external architectural applications.

BS 1615 1987. Method of specifying anodic oxidation coatings on aluminium and its alloys.

BS 6496 1984. Specification for powder organic coatings for application and stoving to aluminium alloy extrusions, sheet and perforated sections for external architectural purposes.

BBA 88/2028. The Syntha Pulvin System.

BBA 19/2704. Interpon D Systems.

■ Specification

- The installation of the product must be carried out in accordance with standard specification clauses. For example, the relevant clauses contained in the National Building Specification are:
 - L1-330 Aluminium Windows
 - L2-370 Door Frames
 - L1-710 Protection of Components
 - L2-710 Protection of Components
 - L1-550 Metal Glazed Screens

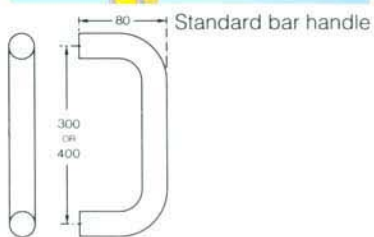
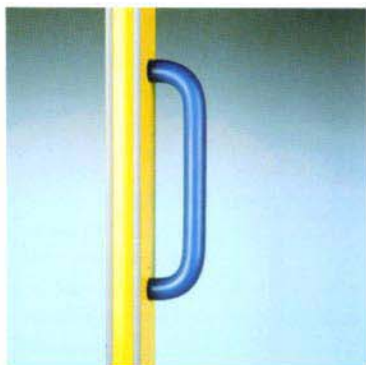

Standard bar handle

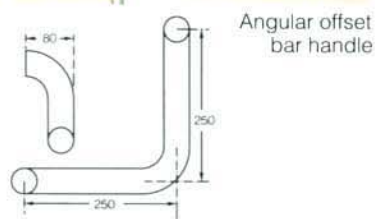
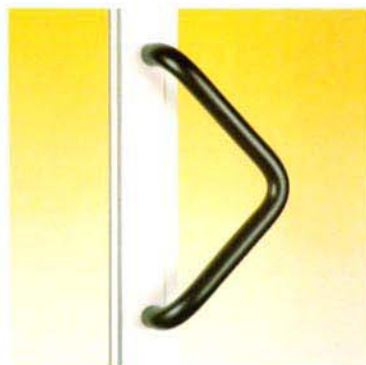

Angular offset bar handle

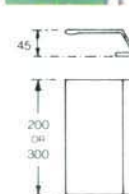
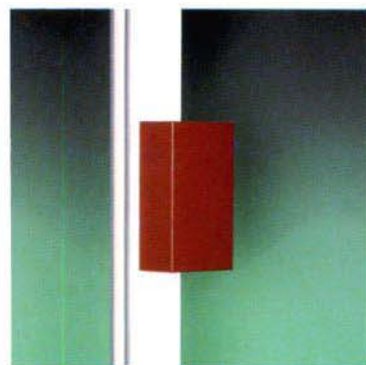

Plain pad

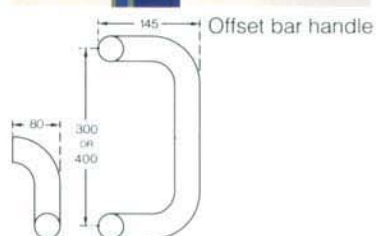
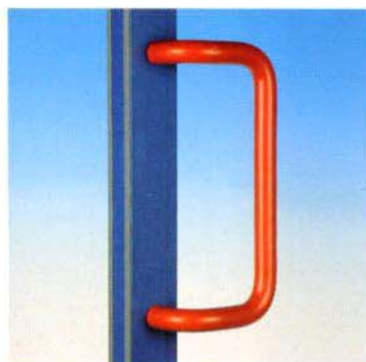

Offset bar handle

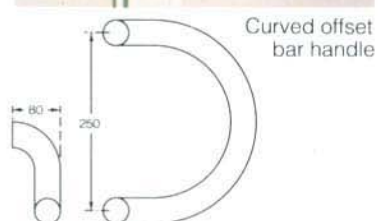

Curved offset bar handle

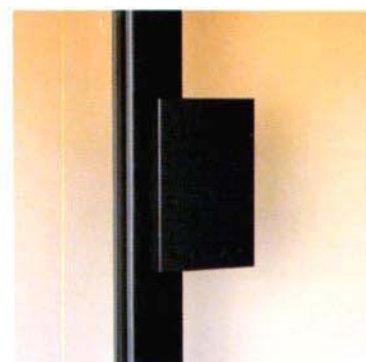

Broad faced pad

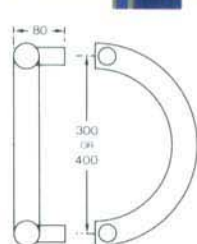
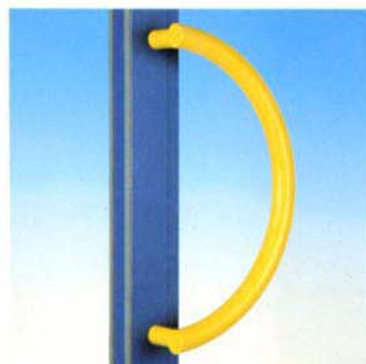

D bar handle

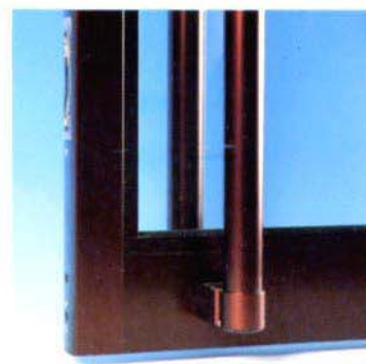

Tube handle



Ribbed pad

202 SINGLE & DOUBLE DOORS

■ Description

- Single or double action hinged, pivot or rebated opening in or out.
- May be fitted individually or as part of multi-entrance shopfronts or office screens.
- Pivoted doors are hung on closers concealed in transoms.
- Hinged doors are hung on pivot hinges.
- A range of handle furniture is available.
- Pivoting doors can accommodate a wide range of operating hardware including under floor closers, panic bolts and automatic closer mechanisms.

202 STORMFORCE DOORS

■ Description

- The unique 202 Stormforce Door has all the features of the standard 202 single and double door range coupled with a double seal for high exposure applications.
- Mitred construction and dual weather seal provide high strength and weather performance.
- Pivot and related doors can additionally accommodate transom closers.
- Excellent weather performance.

■ Product Combinations

- 202 Stormforce Doors may be used with 202 Ground Floor Framing or incorporated directly into Glostal 313 Curtain Walling.

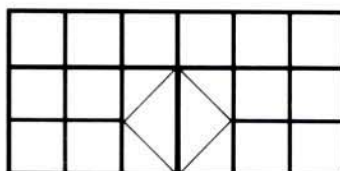
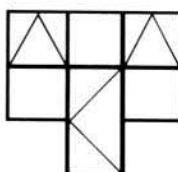
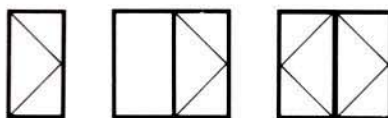

■ Materials

- Aluminium profiles are extruded from aluminium alloy 6060T5 or T6 or 6063T5 or T6 to BS 1474.
- Weather sealing on 202 Stormforce Doors is by polypropylene backed woven pile to outside with silicone flipper seal to inside.
- The rebated condition features extruded synthetic rubber trims and silicone bulb seals. This allows free circulation of air within the rebate cavity resulting in effective drainage.
- Fittings and accessories may vary to accommodate various conditions.

■ Size and Weight Limitations

Width max	1100
Height max	2130
Weight max	90 kg

All dimensions are in mm

Consideration of closer hardware must be given when specifying sizes and weights of 202 Stormforce Doors.

■ Weather Performance

- 202 Stormforce Doors meet the following requirements as specified in BS 6375 Part 1: 1989.

Single/Double Pivot Doors

- Air permeability; 300 Pa
- Water tightness; 300 Pa
- Wind resistance; 1200 Pa

Single/Double Rebate Doors (open-in)

- Air permeability; 200 Pa
- Water tightness; 200 Pa
- Wind resistance; 1200 Pa

Single/Double Rebate Doors (open-out)

- Air permeability; 600 Pa
- Water tightness; 600 Pa
- Wind resistance; 2000 Pa

The above assumes doors are fitted with standard hardware. Performance figures may vary with different hardware options e.g. exit devices.

■ Construction

- Door leaf profiles are mitre cut at 45° and assembled using specially prepared two part corner cleats and ties.
- Cleats are secured by a machine screw tightened on a line perpendicular to the plane of the mitre. A particularly rigid joint is therefore created.
- Joints are sealed against the entry of water.

■ Security

- All doors feature an Adams Rite MS2200 security lock with hook bolt and European standard profiled cylinders plus Adams Rite 4022 threshold bolt.
- Double doors also feature armour strike on slave leaf.
- Options include master key systems, automatic door operation and electronic opening may be specified.

■ Glazing

- Glazing of 24mm thickness can be accommodated.
- Glass is retained by internal beads providing additional security.
- All glass and glazing must conform to the requirements of BS 6262 for size and thickness.

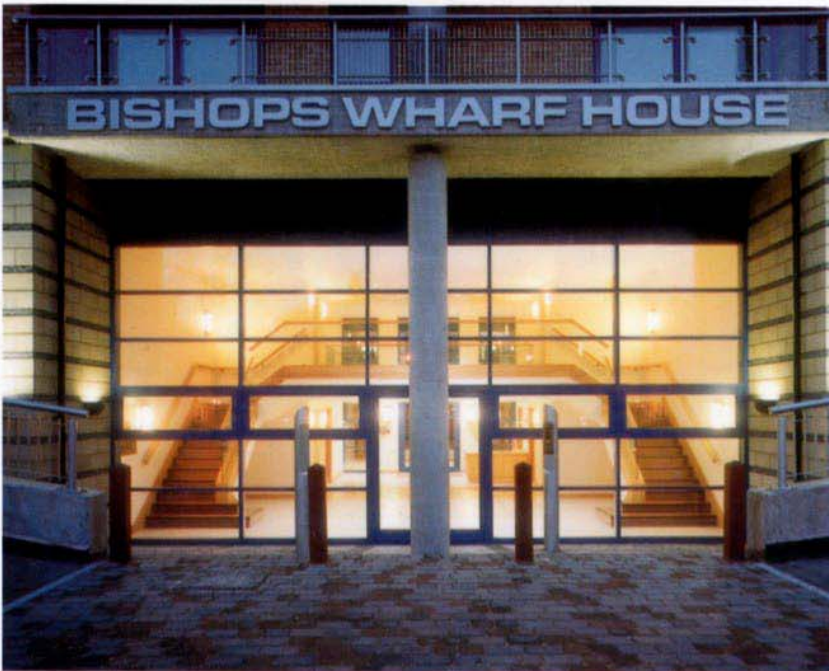

Bishops Wharf House, London
PRODUCTS USED
 202 Commercial Doors, 312 Curtain
 Walling, 317 Dual Colour Windows
FINISH
 Polyester Powder Coated



Newbury Race Course
PRODUCTS USED
 202 Commercial Doors
FINISH
 Polyester Powder Coated

■ 202 Stormforce Door into 313
Curtain Walling, head detail.

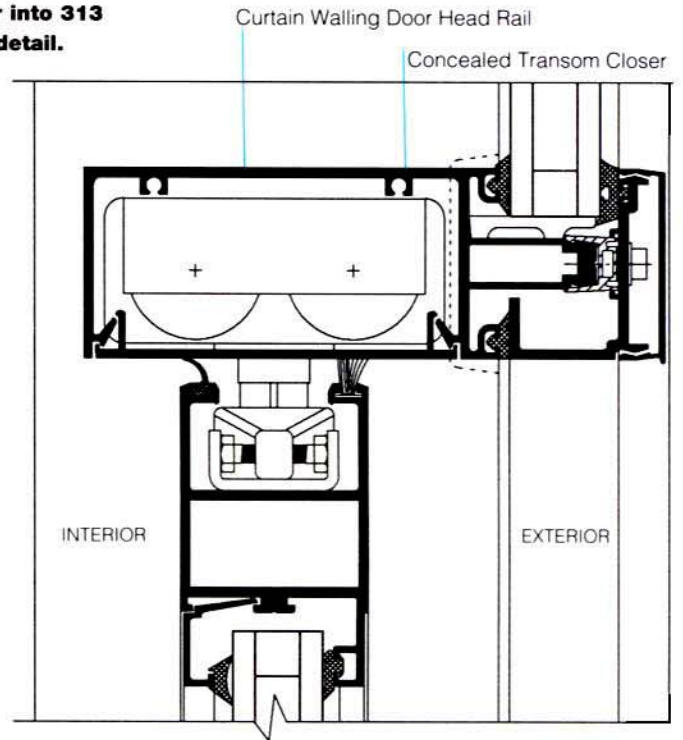
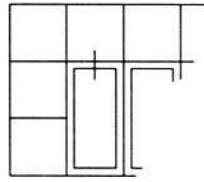

■ 202 Anti Finger Trap Stiles
hanging jamb detail.

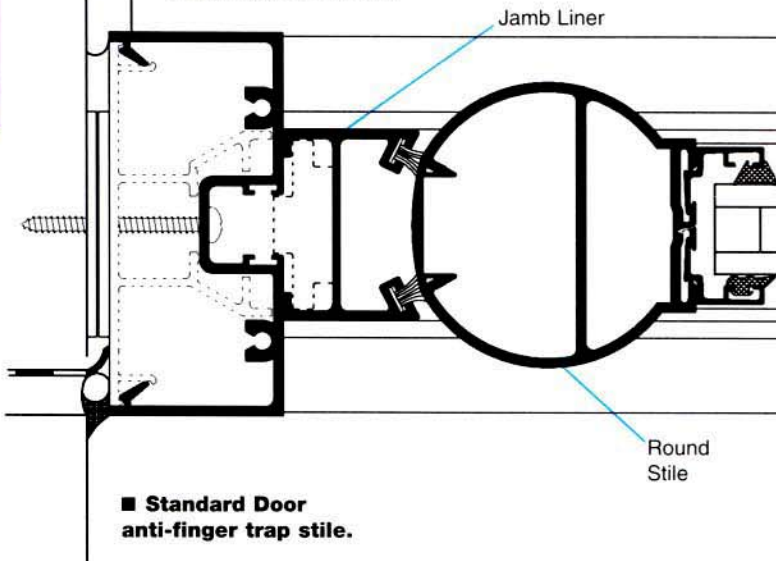

■ Standard Door
anti-finger trap stile.

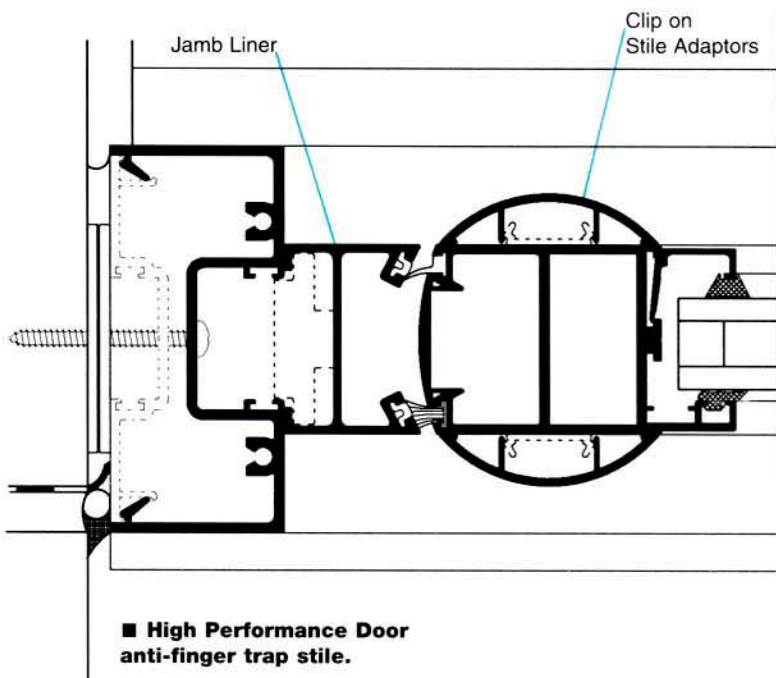

■ High Performance Door
anti-finger trap stile.

■ 202 Stormforce
Centre Pivot Door,
cill detail.

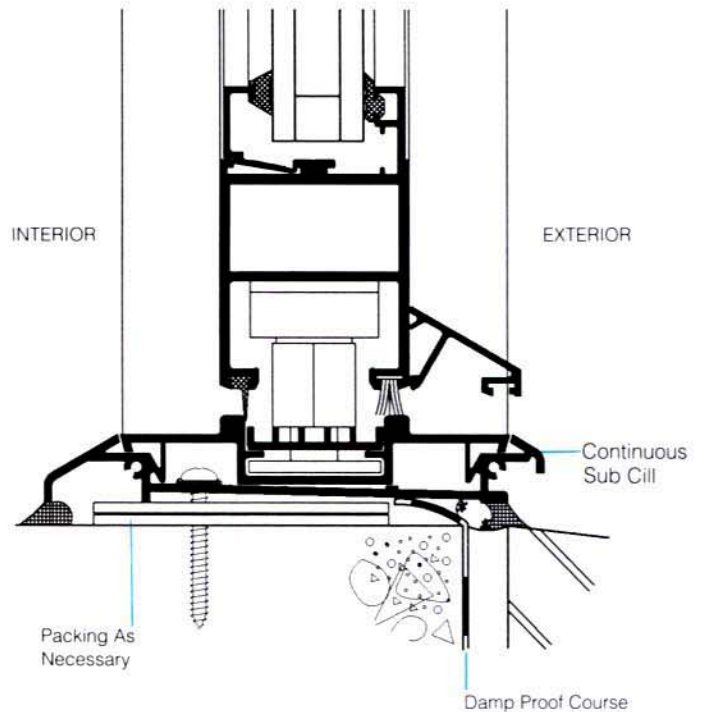
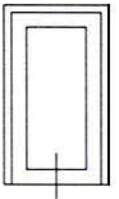

Please note: Whilst the sectional drawings portrayed are accurate they should not be used for any form of reproduction as they are not to a recognised scale.

GENERAL ARRANGEMENTS

Centre Pivot Door

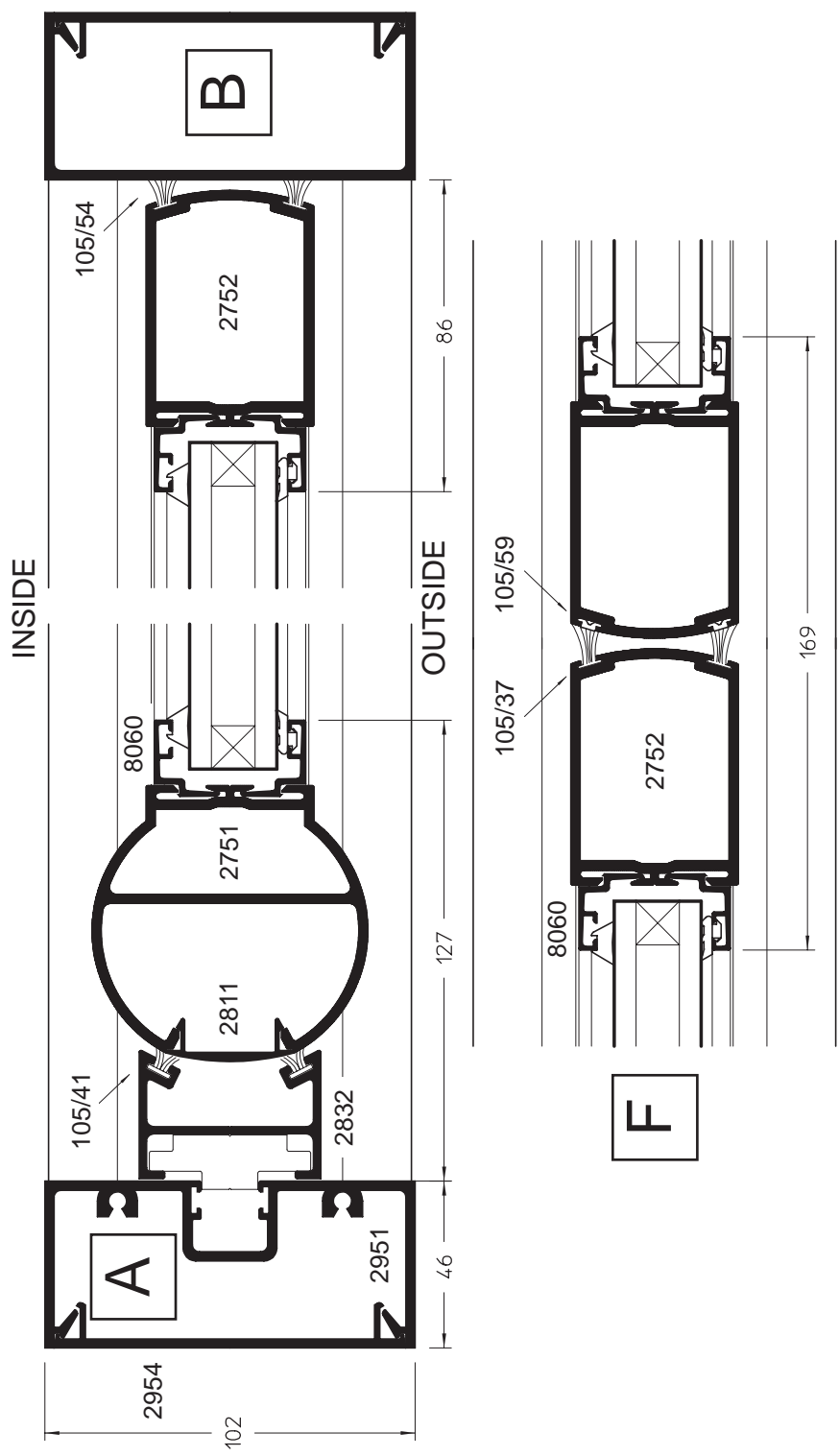

* = opposite hand to that shown

Centre Pivot Door

sapa:

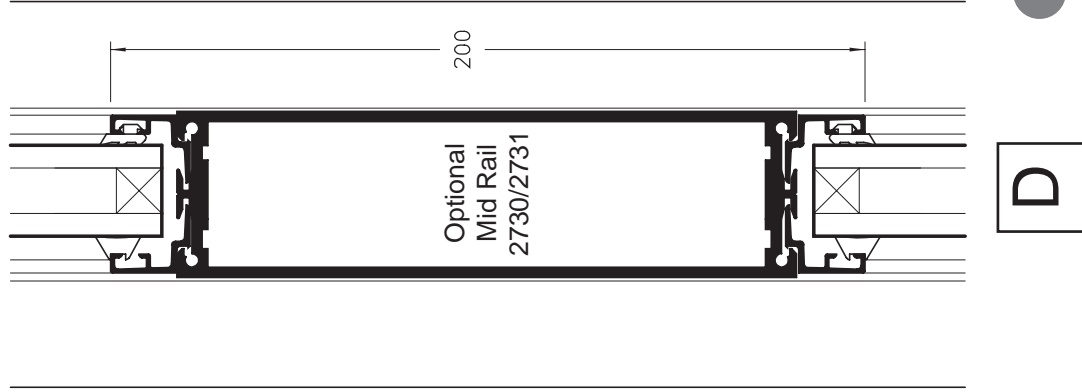
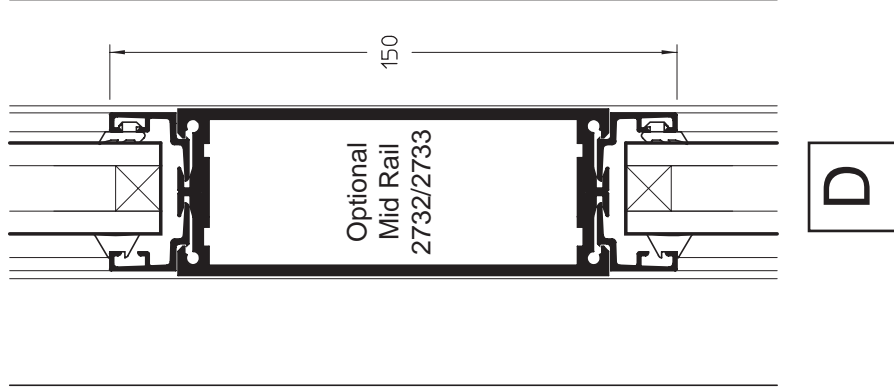
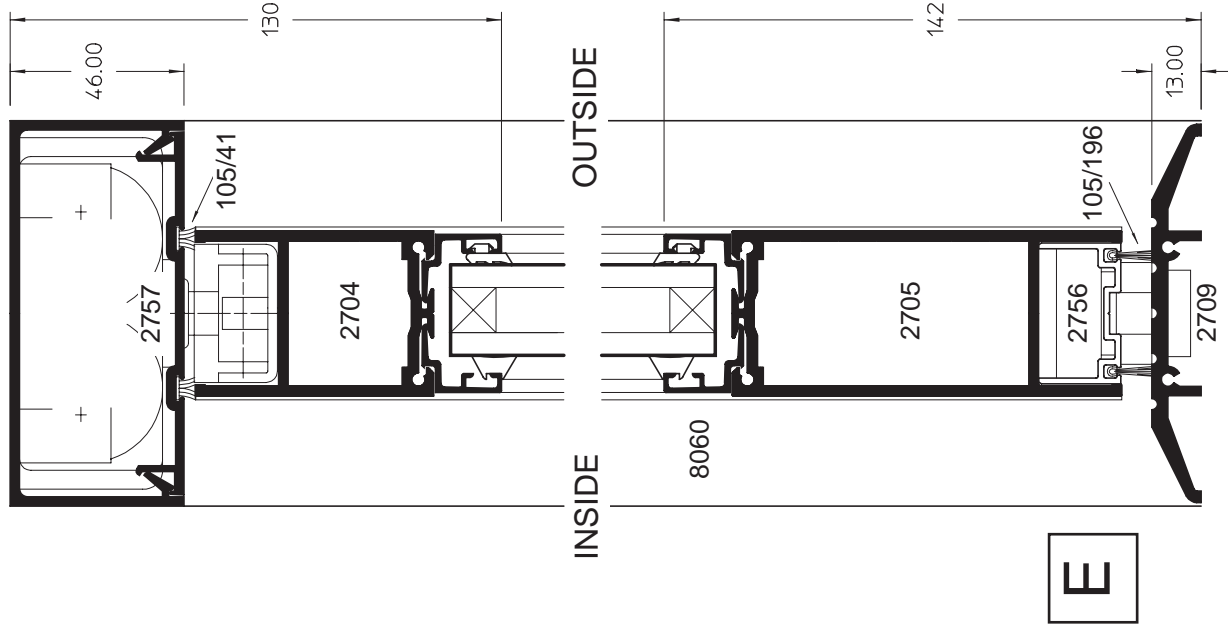

GENERAL ARRANGEMENTS

Standard Stile Options

Centre Pivot & Rebate

Centre Pivot Shown

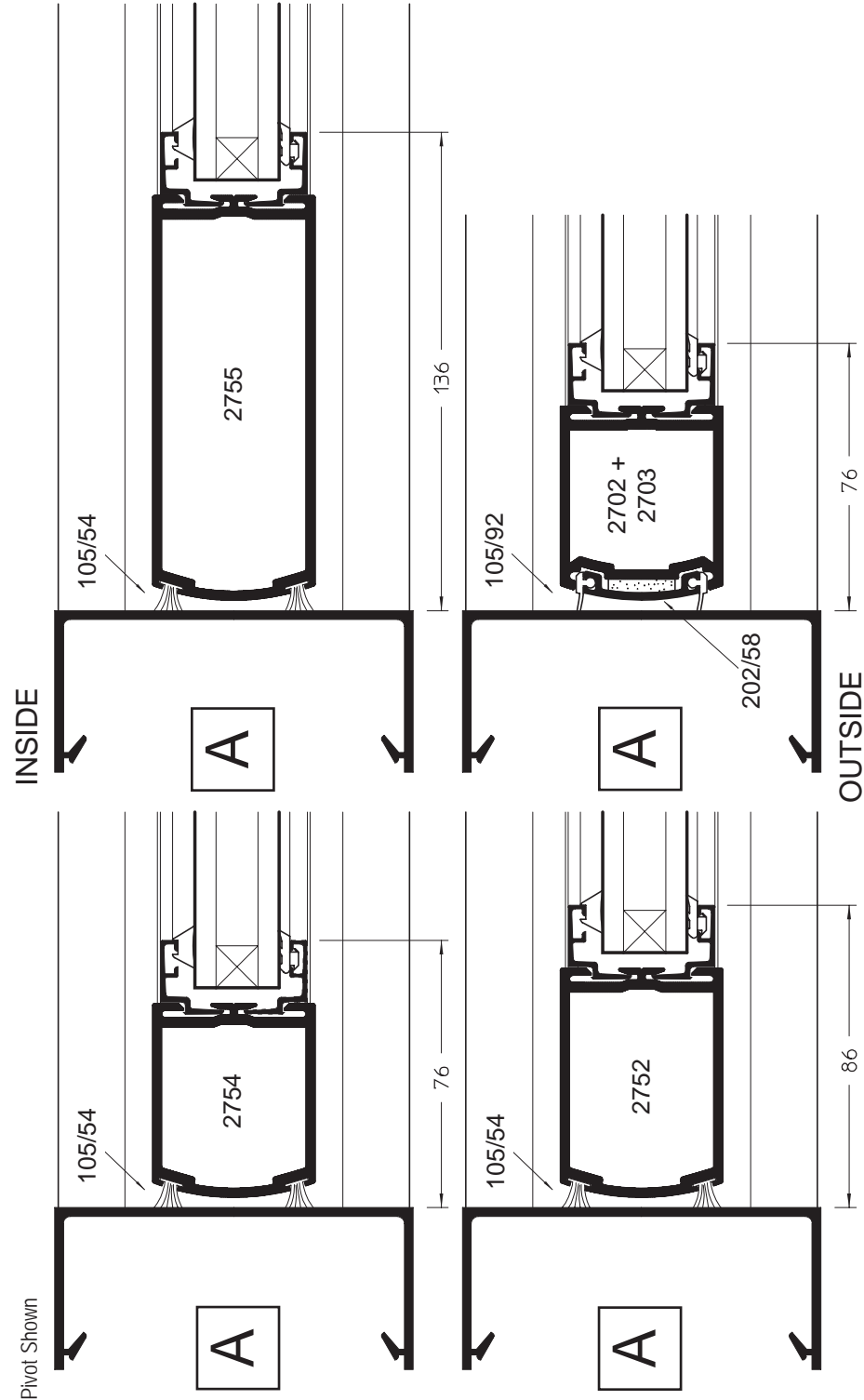

* = opposite hand to that shown

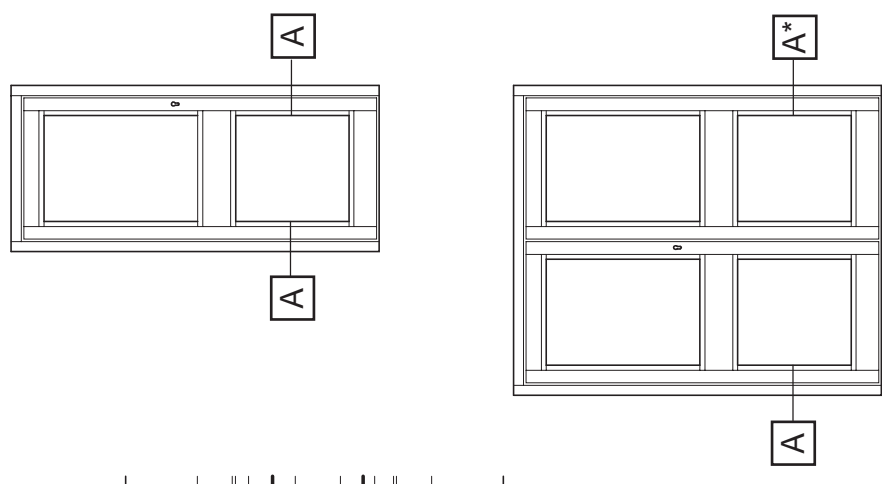

Standard Stile Options

Centre Pivot & Rebate

Centre Pivot Shown

sapa:

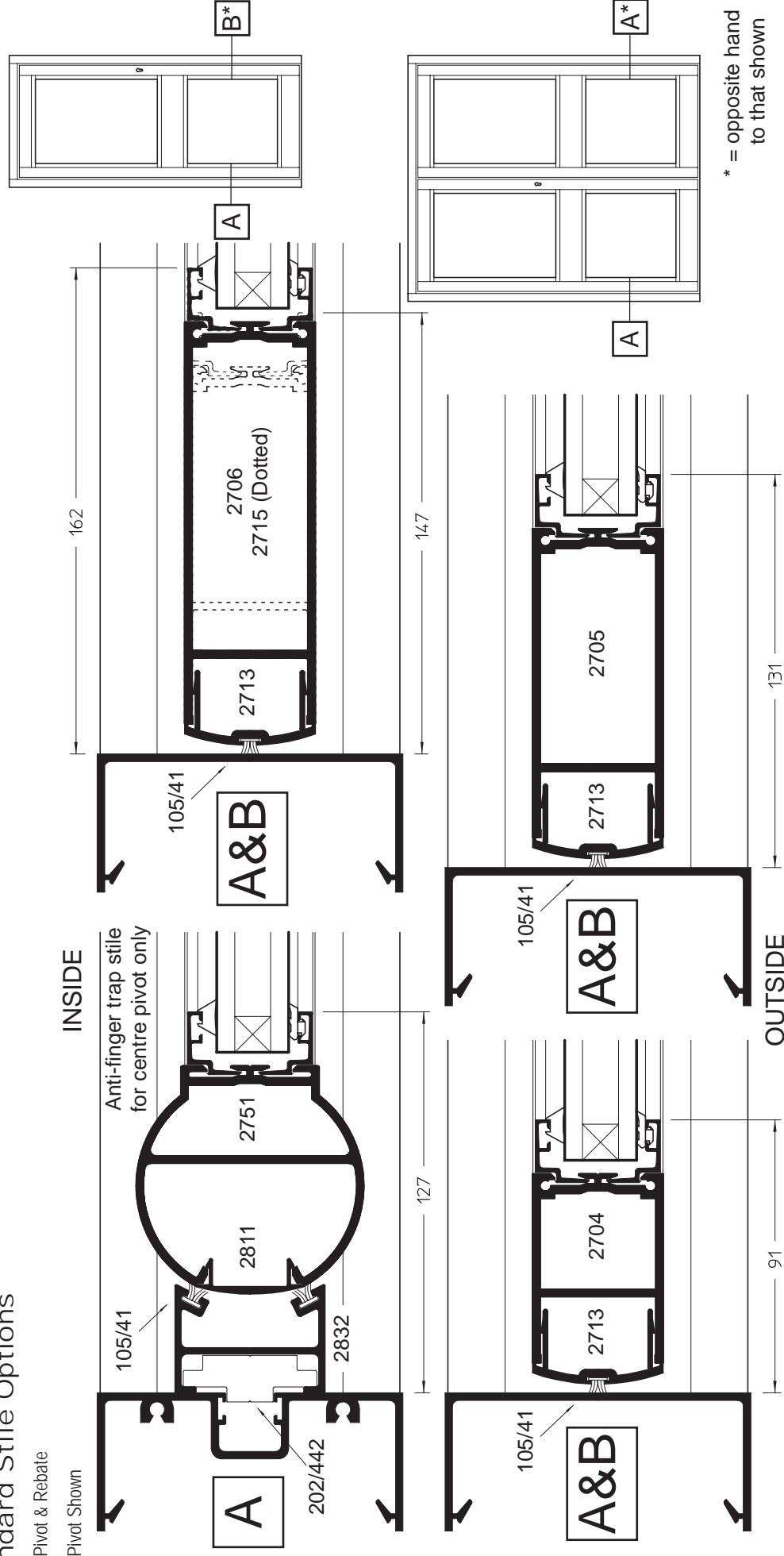



sapa:

202 Non-thermally Broken Commercial Entrance Door & Framing

GENERAL ARRANGEMENTS

Standard Meeting Stile Options
Centre Pivot & Rebate

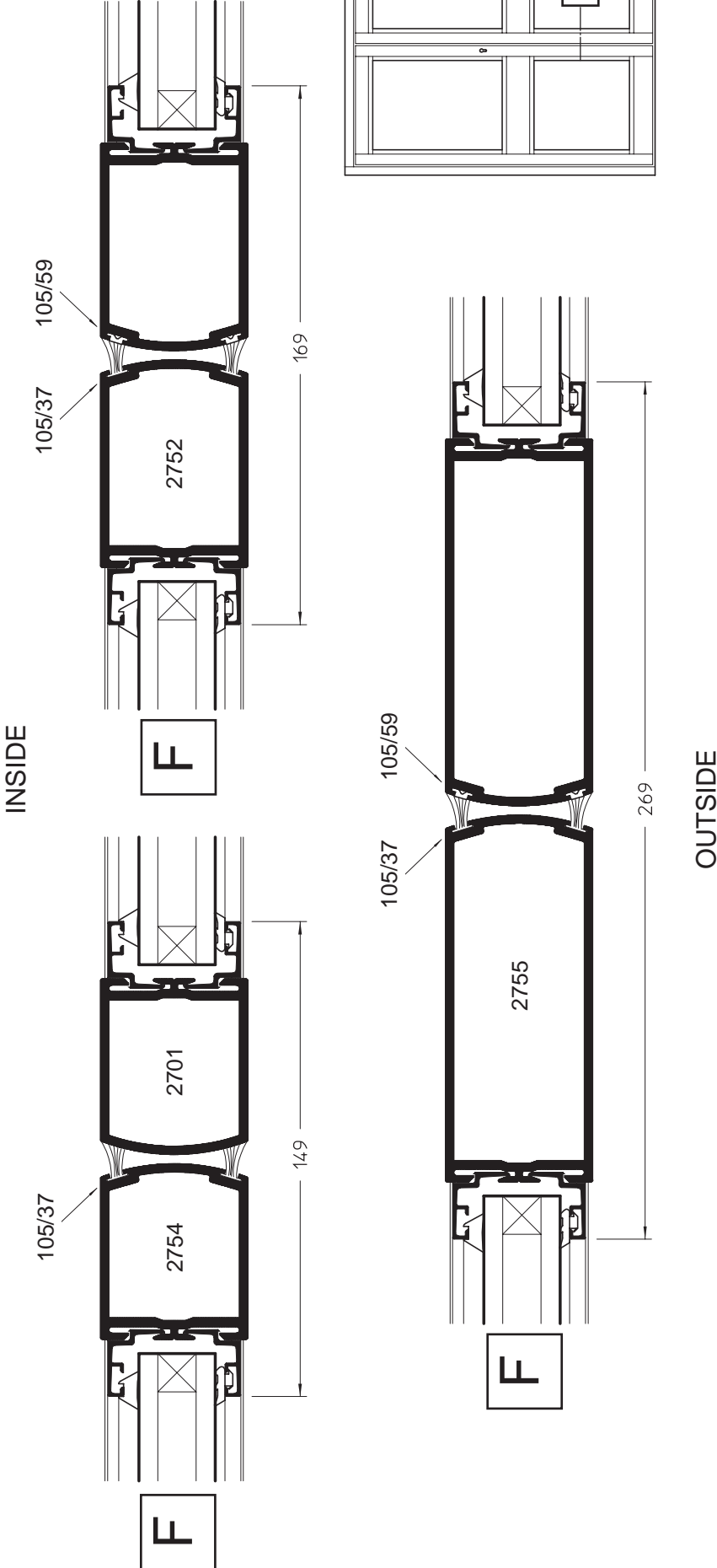

GENERAL ARRANGEMENTS

Standard Meeting Stile Options

Centre Pivot & Rebate

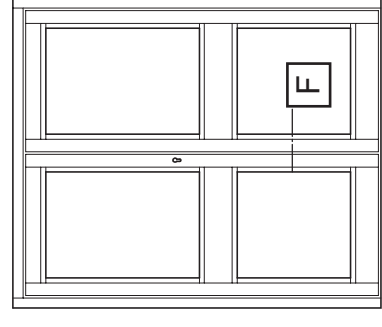
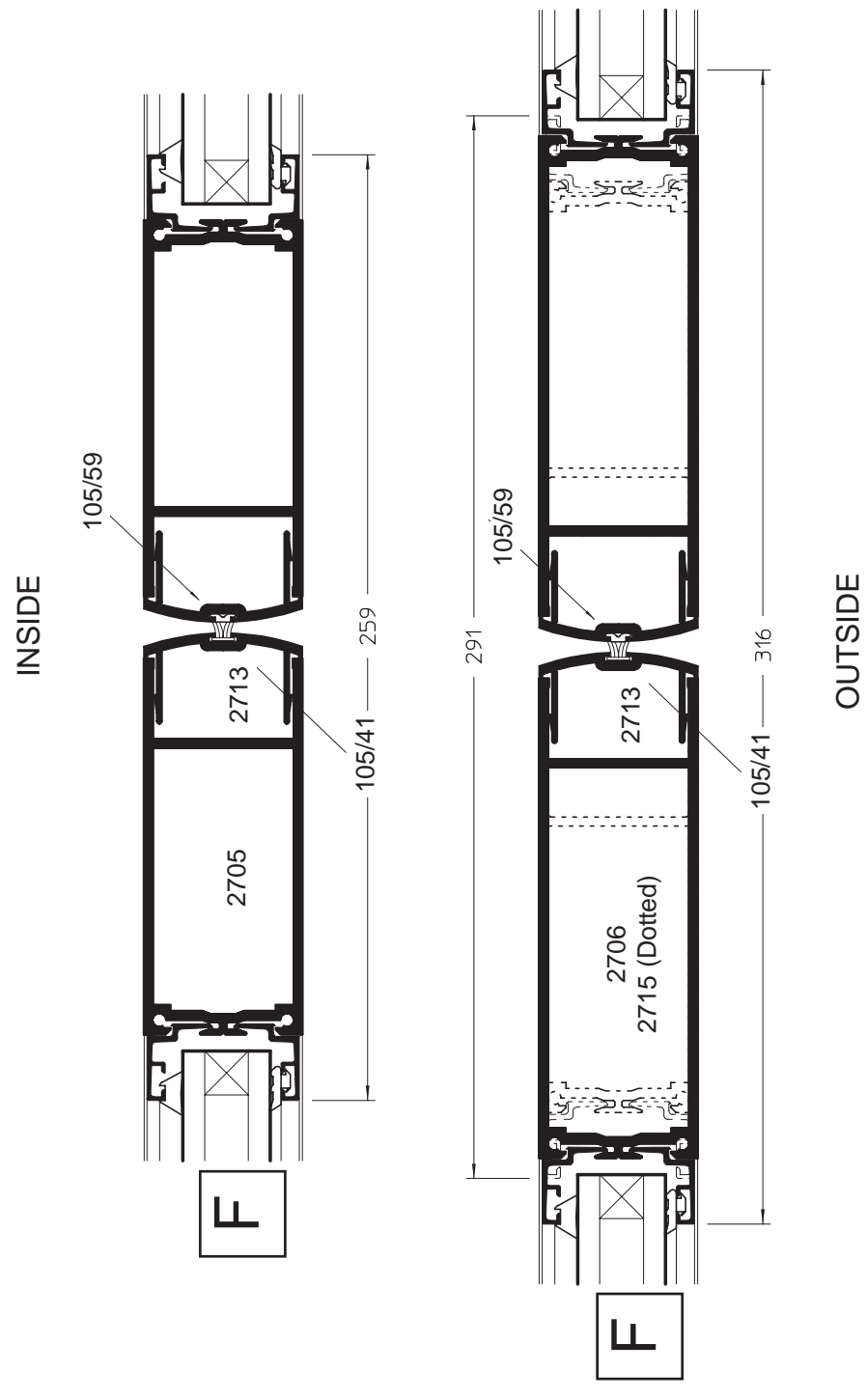



sapa:

202 Non-thermally Broken Commercial Entrance Door & Framing

GENERAL ARRANGEMENTS

Standard Top Rail Options

Centre Pivot & Rebate

Centre Pivot Shown

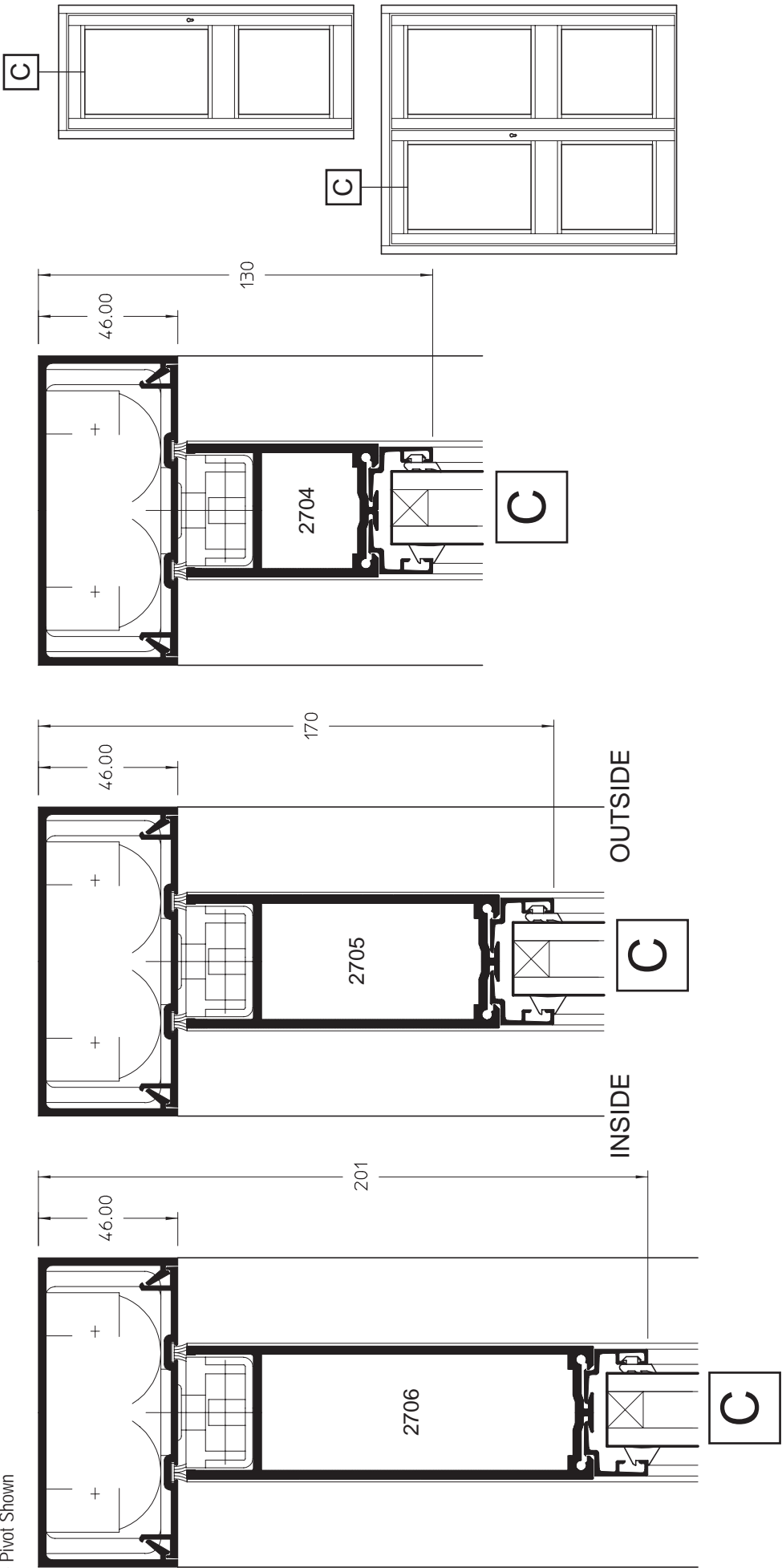

Standard Bottom Rail Options

Centre Pivot & Rebate

Centre Pivot Shown

sapa:

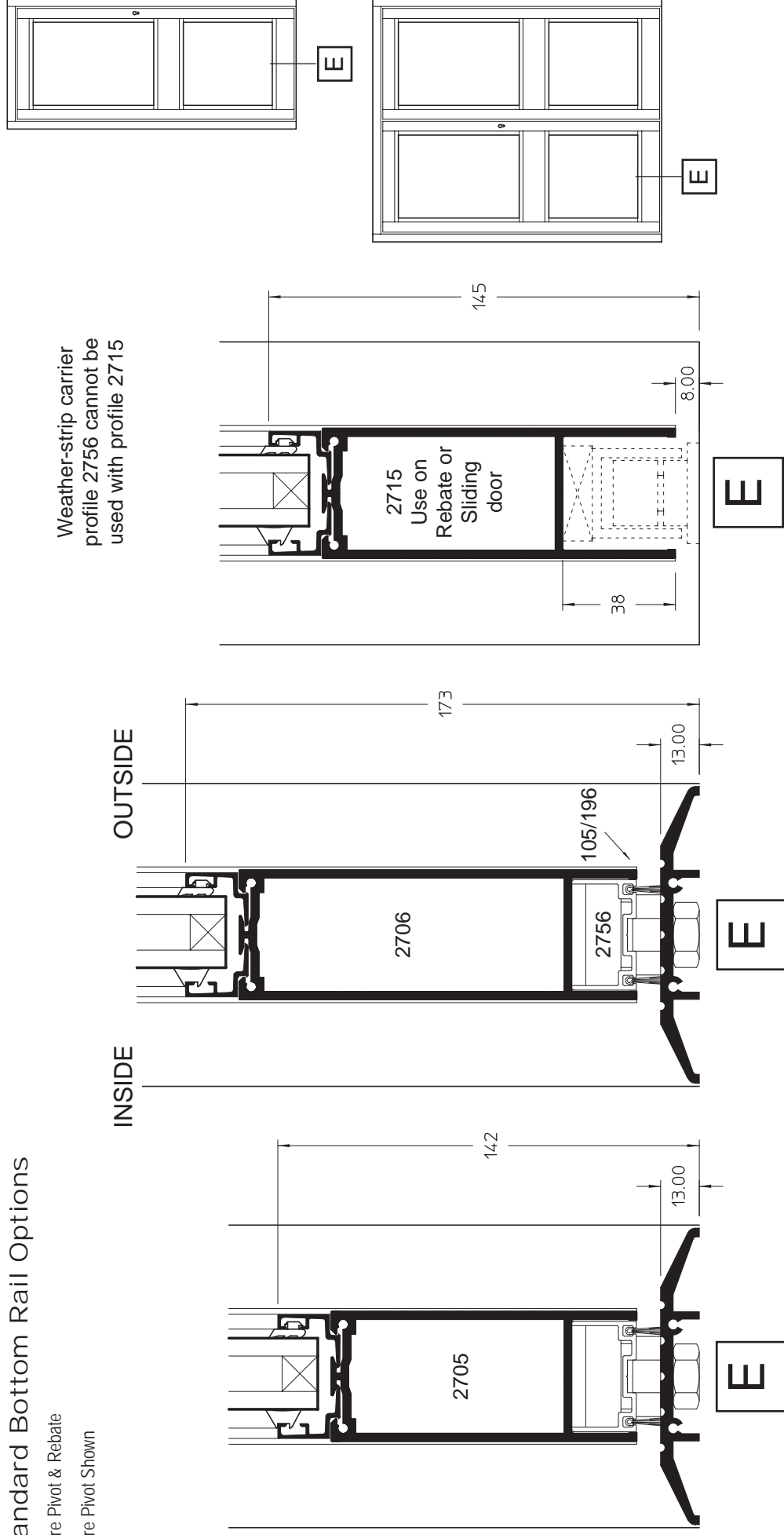



sapa:

202 Non-thermally Broken Commercial Entrance Door & Framing

GENERAL ARRANGEMENTS

Standard Lay Bar & Mid Rail Options

Centre Pivot & Rebate

Centre Pivot Shown

D

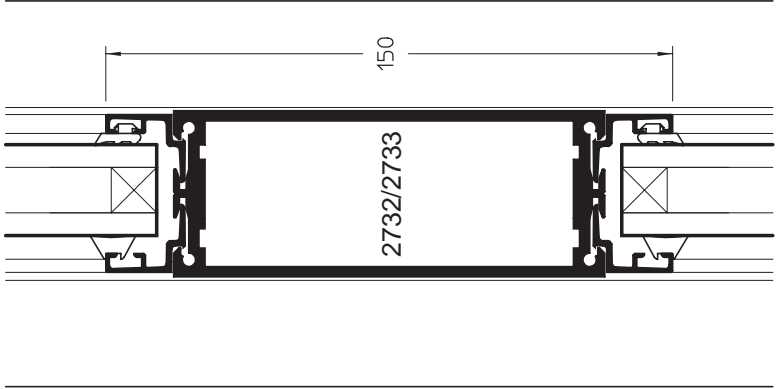
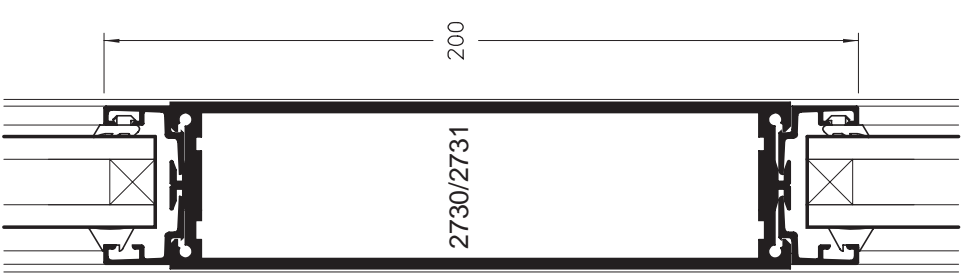

D

G

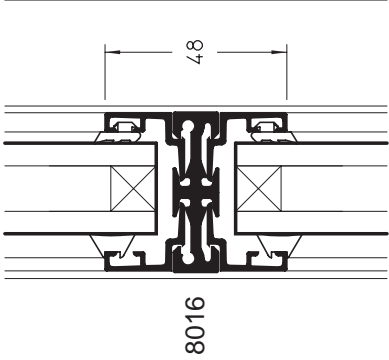

INSIDE

OUTSIDE

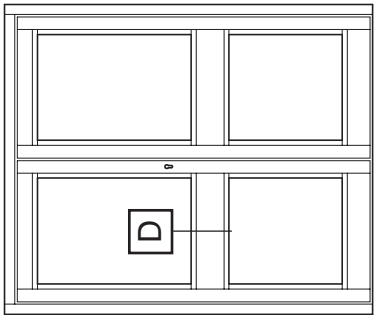
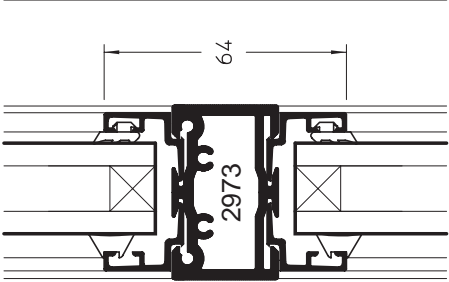
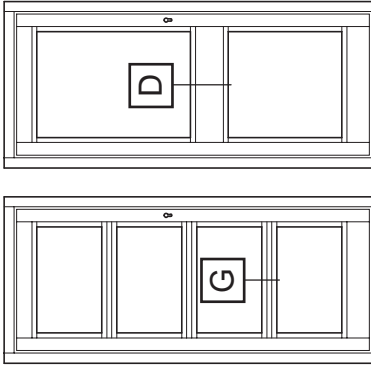

Standard Door Head/Transom Options

Centre Pivot

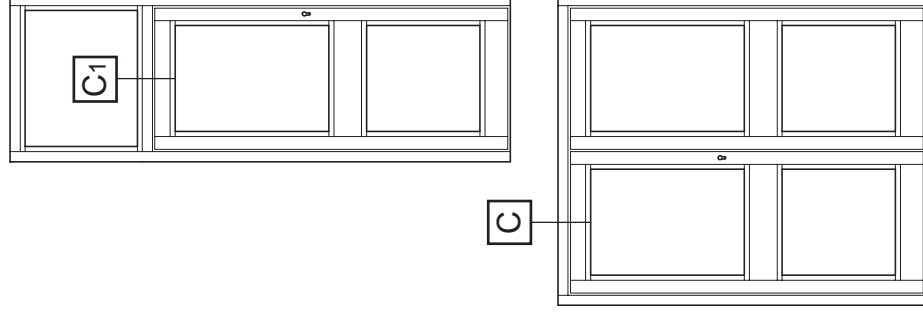
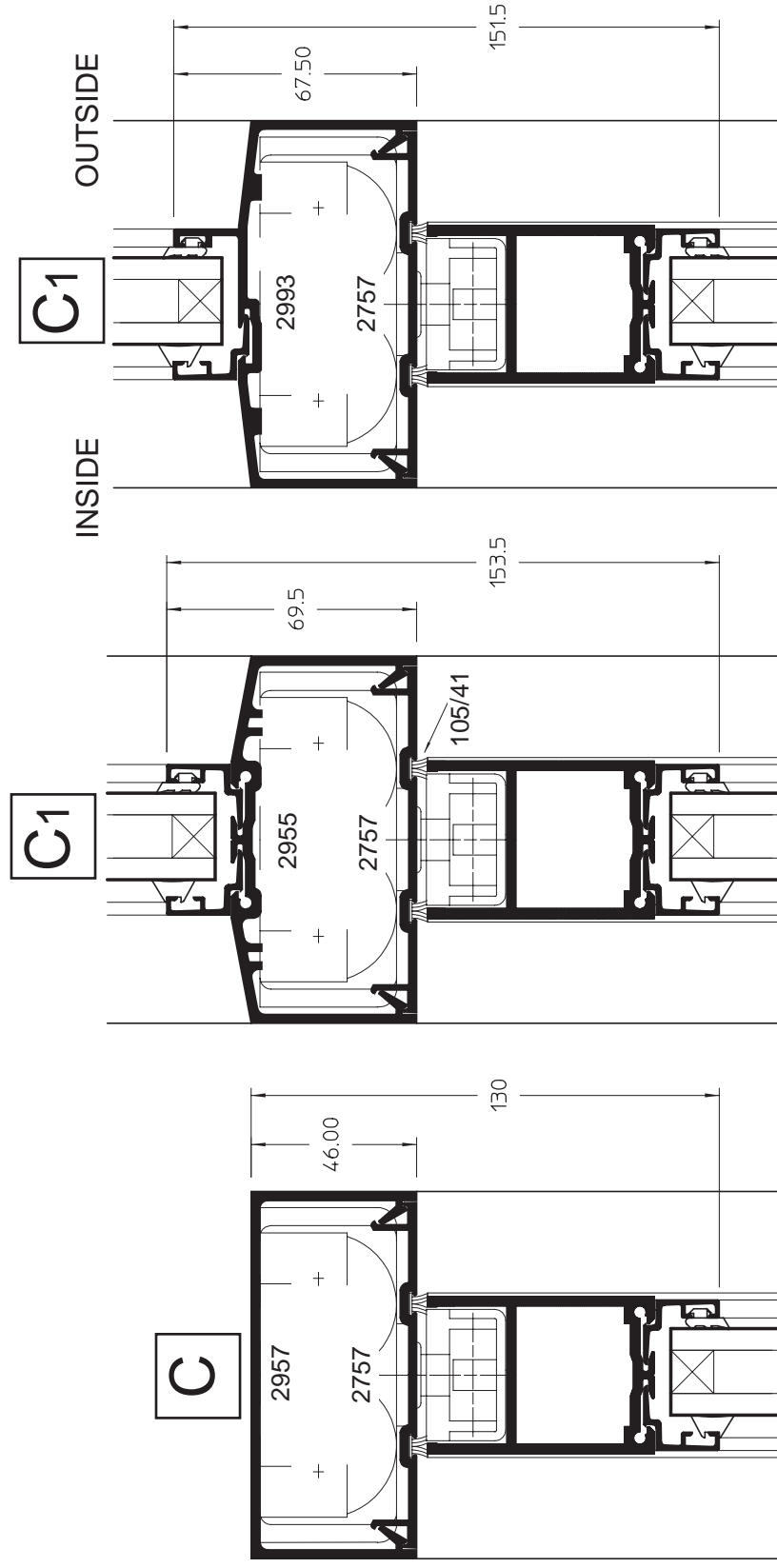



sapa:

202 Non-thermally Broken Commercial Entrance Door & Framing

GENERAL ARRANGEMENTS

Standard Door Head/Transom Options

Rebate

Open out door shown,
Mirror illustration for open
in door, with the exception
of profiles 2981 & 2984

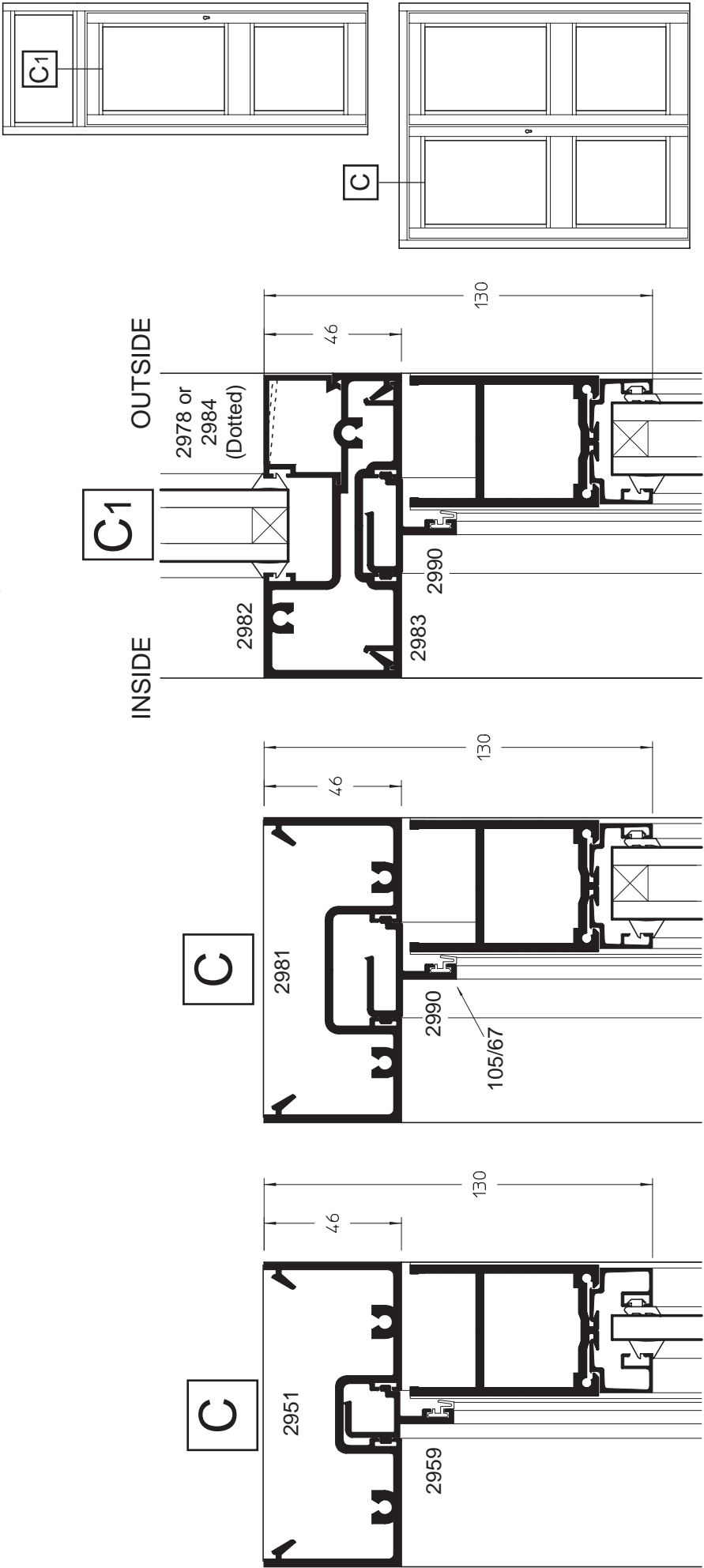

Standard Door Transom Options

Rebate

sapa:

Open out door shown, Mirror illustration for open in door, with the exception of profiles 2952, 2966 or 2967 & 2996

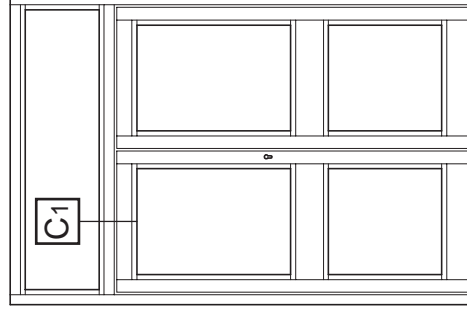
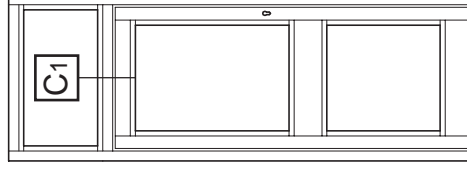
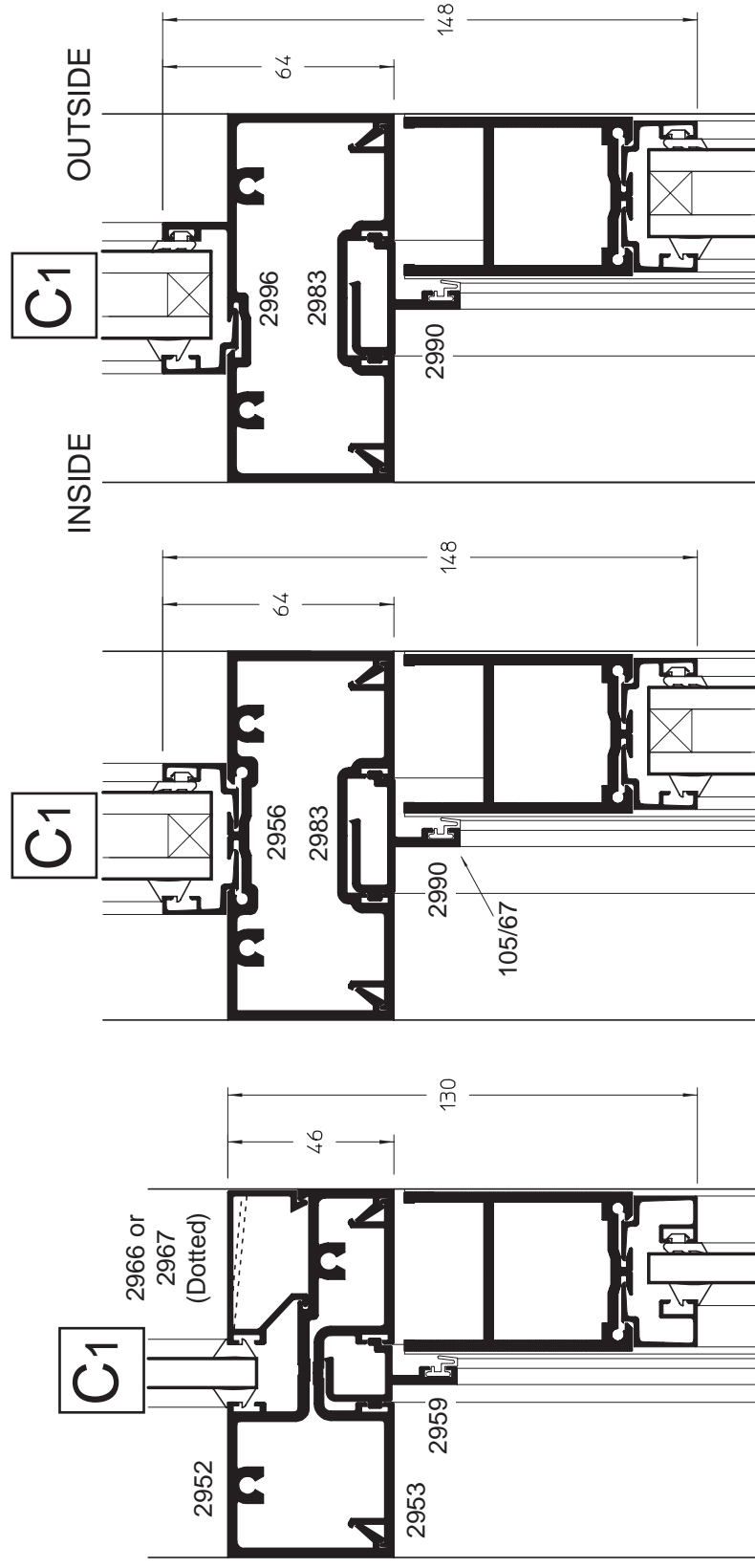

Standard Door Cill Options

Centre Pivot

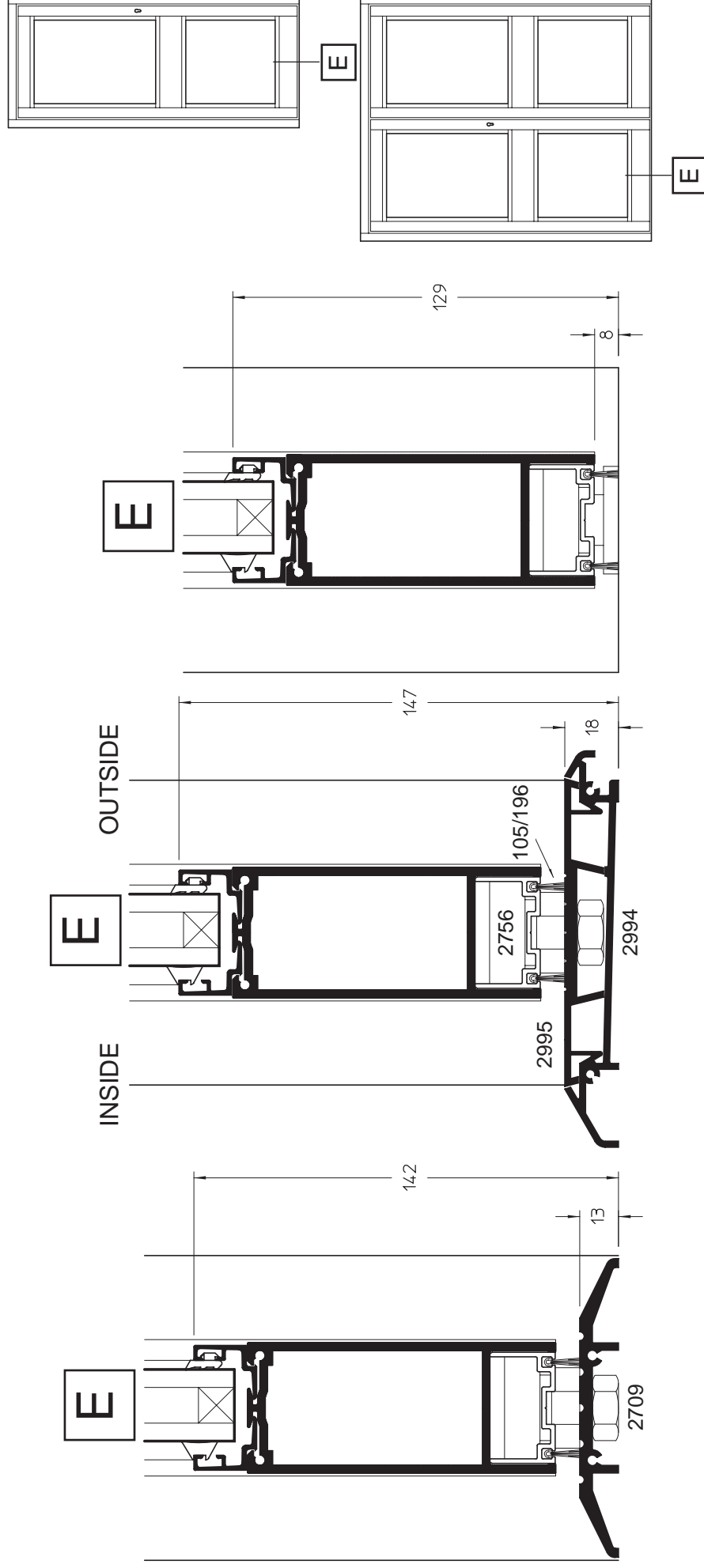

Standard Door Jamb Options

Centre Pivot

* = opposite hand to that shown

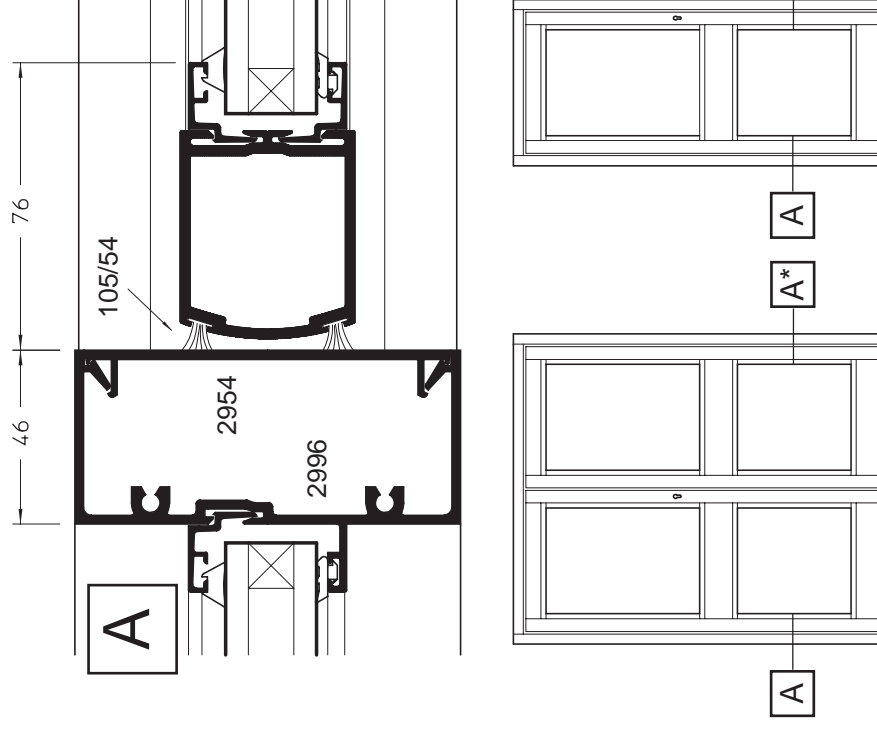
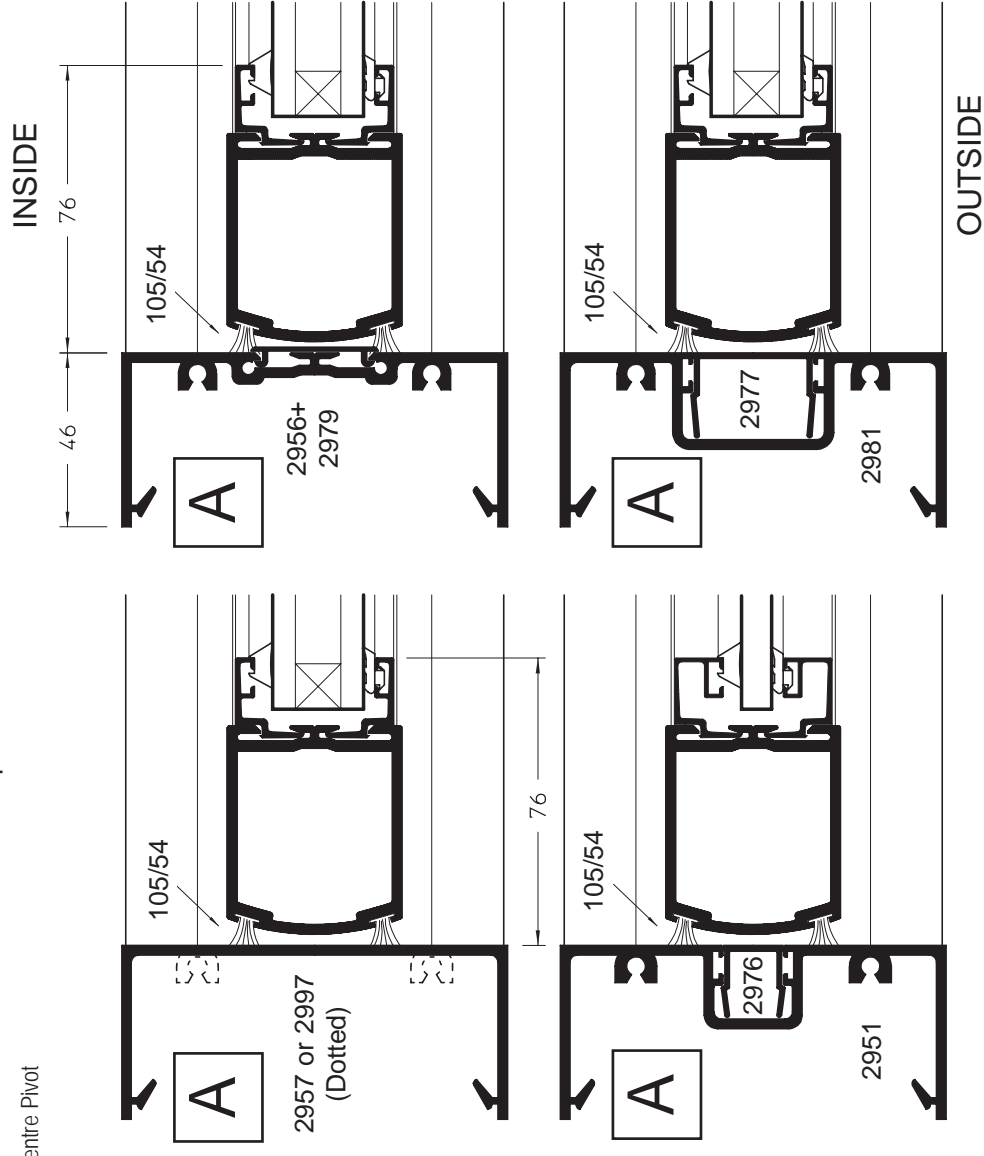

GENERAL ARRANGEMENTS

sapa:

Open in door shown,
Mirror illustration for
open out door, with the
exception of profile 2996

* = opposite hand
to that shown

